

PF 2 30 152 004

Winkel 45° PVC-U metrisch

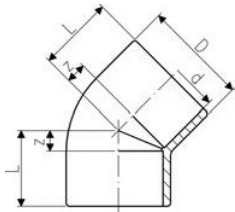

| d (mm) | d (inch) | PN (bar) | Code | SP | Gewicht (kg) | z (mm) | D (mm) | L (mm) |
|-----------|-------------|-------------|-------------|----|-----------------|-----------|-----------|-----------|
| 16 | | 16 | 721 150 105 | 10 | 0,008 | 5 | 21 | 19 |
| 20 | | 16 | 721 150 106 | 10 | 0,011 | 5 | 25 | 21 |
| 25 | | 16 | 721 150 107 | 10 | 0,017 | 6 | 31 | 25 |
| 32 | | 16 | 721 150 108 | 10 | 0,021 | 8 | 38 | 30 |
| 40 | | 16 | 721 150 109 | 10 | 0,048 | 10 | 47 | 36 |
| 50 | | 16 | 721 150 110 | 5 | 0,086 | 12 | 59 | 43 |
| 63 | | 16 | 721 150 111 | 5 | 0,160 | 14 | 73 | 52 |
| 75 | 2 1/2 | 16 | 721 150 112 | 5 | 0,253 | 17 | 87 | 61 |
| 90 | | 16 | 721 150 113 | 4 | 0,430 | 20 | 105 | 71 |
| 110 | | 16 | 721 150 114 | 4 | 0,750 | 25 | 127 | 86 |
| 125 | | 16 | 721 150 115 | 1 | 1,193 | 28 | 146 | 97 |
| 140 | 5 | 16 | 721 150 116 | 1 | 1,570 | 32 | 162 | 108 |
| 160 | | 16 | 721 150 117 | 4 | 2,280 | 36 | 185 | 122 |
| 200 | | 10 | 721 150 119 | 2 | 3,288 | 43 | 225 | 149 |
| 225 | | 10 | 721 150 120 | 1 | 4,191 | 49 | 250 | 168 |
| 250 | | 10 | 721 150 121 | 1 | 7,115 | 60 | 282 | 192 |
| 280 | | 10 | 721 150 122 | 1 | 10,340 | 66 | 318 | 213 |
| 315 | | 6 | 721 150 123 | 1 | 14,292 | 74 | 356 | 239 |
| 400 | | 6 | 721 150 125 | 1 | 25,268 | 94 | 442 | 302 |

PF 2 30 152 004

PRO-FIT Winkel 45° PVC-U metrisch

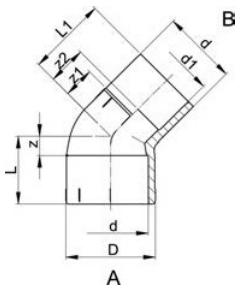

Ausführung:

- Abgang A = Klebemuffe metrisch
- Abgang B = Klebestutzen kombiniert mit reduzierter Klebemuffe metrisch
- Direkte Verbindung Fitting mit Fitting ermöglicht kürzeste Baulänge

| d (mm) | d1 (mm) | PN (bar) | Code | SP | Gewicht (kg) | z (mm) | z1 (mm) | z2 (mm) | D (mm) | L (mm) | L1 (mm) |
|-----------|------------|-------------|-------------|----|-----------------|-----------|------------|------------|-----------|-----------|------------|
| 20 | 16 | 16 | 721 150 306 | 10 | 0,010 | 5 | 9 | 11 | 25 | 21 | 25 |
| 25 | 20 | 16 | 721 150 307 | 10 | 0,015 | 6 | 11 | 14 | 31 | 25 | 30 |
| 32 | 25 | 16 | 721 150 308 | 10 | 0,027 | 8 | 13 | 16 | 38 | 30 | 35 |
| 40 | 32 | 16 | 721 150 309 | 5 | 0,053 | 10 | 17 | 21 | 47 | 36 | 43 |
| 50 | 40 | 16 | 721 150 310 | 5 | 0,090 | 12 | 18 | 23 | 58 | 43 | 49 |
| 63 | 50 | 16 | 721 150 311 | 5 | 0,175 | 14 | 23 | 30 | 73 | 52 | 61 |